

Resistive Linear Position Transducer



- Measuring range 10mm – 300mm
- Long mechanical life 100.000.000 cycles
- Excellent repeatability
- Very low temperature drift
- Infinite resolution

Main Applications

Metal Forming Machines, Textile Machines, Packing Machines, Printing Machines, Marble/ Stone Machines and General Automation Applications

Specifications

Mechanical stroke	10mm to 300mm
Linearity	± %0,05
Resolution	Infinite
Resistance output	5 Kohm or 10 Kohm
Resistance tolerance	± %20
Load resistance	Min. 100 Kohm
Repeatability	≤ %0.01
Mechanical life	100 * 10 ⁶ Cycles
Displacement speed	≤ 5 m/s
Permissible applied voltage	28 VDC max
Recommended cursor current	< 1 μA
Electrical connections	cable (30cm)
Case dimensions	Ø 18mm
Case material	Anodized aluminium
Rod diameter	4mm
Rod material	Stainless steel
IP Degree	IP 65
Working temperature	- 20 / + 80 °C
Mechanical fixing	2 Ball joints

Dimensions

Model	LM	Mechanical stroke (MS)	Electrical measuring stroke (EMS)	Total lengt (L)
SLPC	10	12mm	10mm	106mm
SLPC	25	27mm	25mm	121mm
SLPC	50	52mm	50mm	146mm
SLPC	75	77mm	75mm	171mm
SLPC	100	102mm	100mm	196mm
SLPC	125	127mm	125mm	221mm
SLPC	150	152mm	150mm </td <td>246mm</td>	246mm
SLPC	175	177mm	175mm	271mm
SLPC	200	202mm	200mm	296mm
SLPC	250	252mm	250mm	346mm
SLPC	300	302mm	300mm	396mm

Ordering Procedure

SLPC <i>Model</i>	200 <i>Measurement Stroke</i>	D <i>Linearity Class</i> D: 0,05 %	5K <i>Kohm Value</i> 5K: 5 KΩ 10K: 10 KΩ
----------------------	----------------------------------	--	---

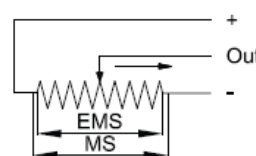
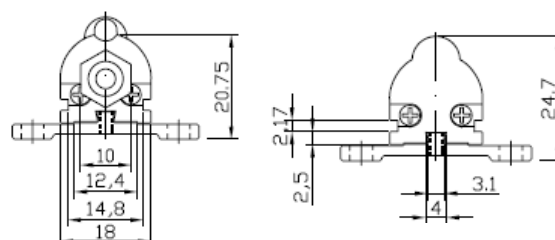
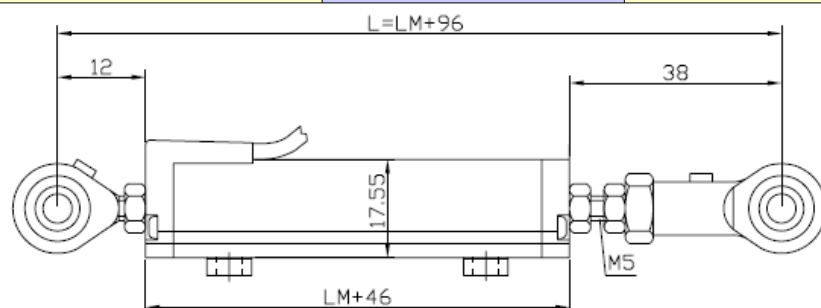

EMS= Electrical Measuring Stroke
MS = Mechanical Stroke